

SECOND SECTION

The Boscobel Dial

VOL. 109 — NO. 10

BOSCOBEL, WISCONSIN

THURSDAY, JUNE 16, 1983



ENTRANCE TO NEW LAW ENFORCEMENT CENTER AND SHERIFF HOTTENSTEIN

Open house Sunday at Grant County's new Enforcement Center

The newly remodeled and expanded Grant County Law Enforcement Center will open its doors to the public Sunday, June 19, from 1 to 4 p.m. The facility has capacity for 43 prisoners and increased margin of security.

For three years, prisoners had to be transported to and from other county jails at a considerable cost to the taxpayers. It was not unusual to have officers driving back and forth from the Crawford County Sheriff's Department two to four times per day just for one prisoner. Now other departments, such as the Iowa County Sheriff's Depart-

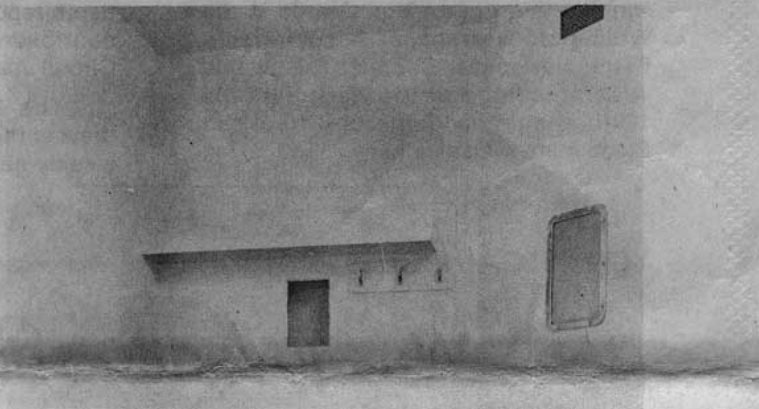

JAIL

[Continued From Page 1]

smoke, smoke and fire detectors have been installed which sound a general alarm and also a local alarm at the site of the disturbance.

The cell facilities break down like this: one holding room, two holding cells, two minimum security, seven maximum security.

Prisoner facilities include a holding room, two holding cells which hold one prisoner each, two minimum security blocks which can hold five prisoners, seven maximum security areas for 17 inmates and three Huber dorms which accommodate 19 prisoners.

The southern end of the facility has over eight miles of wire which connects the cameras, doors and other electronic devices.

Open house program

The speaker for the opening of the new law enforcement center will be Richard Orton of Lancaster, reserve Grant County circuit judge. Following is the program:

Introductions by Francis Busch, chairman of the Law Enforcement Committee.

Welcome by Mary Wirth, county board chairman.

Comments by Sheriff Herbert Hottenstein.

Remarks by Denis Moriarity,



A CELL BLOCK CORRIDOR

at Grant County's new Enforcement Center

The newly remodeled and expanded Grant County Law Enforcement Center will open its doors to the public Sunday, June 19, from 1 to 4 p.m. The facility has capacity for 43 prisoners and increased margin of security.

For three years, prisoners had to be transported to and from other county jails at a considerable cost to the taxpayers. It was not unusual to have officers driving back and forth from the Crawford County Sheriff's Department two to four times per day just for one prisoner. Now other departments, such as the Iowa County Sheriff's Department, are transporting to Grant.

The jail is the original structure, which was remodeled with a sizable new addition. Major changes were made to existing rooms and cell blocks.

Some new features include: a new photo lab, a prisoner intake garage complete with closed circuit TV camera and foot-thick concrete walls and an increased number of cells for Huber prisoners and maximum security inmates. The kitchen was also expanded.

The remodeling included the installation of 40 electrified doors. The doors can either be opened remotely by control panels located at each cell block or they can be over-riden and manually opened in case of a power outage.

The 8 by 10 foot cells have stainless steel toilets, sinks and mirrors. They also feature break-away coat hangers to dissuade would-be suicide attempts.

Security features

On the security side, maximum security cells no longer have access to outside walls. In the past, prisoners had been secreted contraband through screened windows. Now a corridor runs the length of the cell block to buffer the prisoners from the windows. The corridors also serve to give the department better visual inspection of the prisoners.

The maze of cell block corridors all have security doors that require special keys to open them. One key would do a prospective escapee no good at all.



INTERIOR OF A SINGLE CELL

Portion of Hwys. 35 and 133 to be closed for construction

Reconstruction of a 5.6 mile portion of STH 35 and 133 between Bloomington and Patch Grove is scheduled to begin June 20, according to Marvin W. Storm, Transportation Dist. I chief construction engineer.

Work includes grading, improved drainage facilities, gravel base course, curb and gutter in the urban areas, and a recycled bituminous surface on the entire project.

STH 35 and 133 will be closed

during construction. A detour will carry STH 35 traffic north on STH 129 and USH 61 from Lancaster to USH 18 in Fennimore; then west to STH 35 and 133 north of Patch Grove. STH 133 traffic will be detoured north from Bloomington on Fairgrounds Road to USH 18. Completion is expected by late October.

H. James & Sons of Fennimore is the prime contractor. Mike Zeisler will represent the office as project engineer.



DISPATCHER BUD ALLEN MANS THE EQUIPMENT IN THE COMMUNICATIONS ROOM



SHERIFF HERB HOTTENSTEIN AT HIS DESK



OFFICER LaVON BARTELS operates one of cell block control panels.

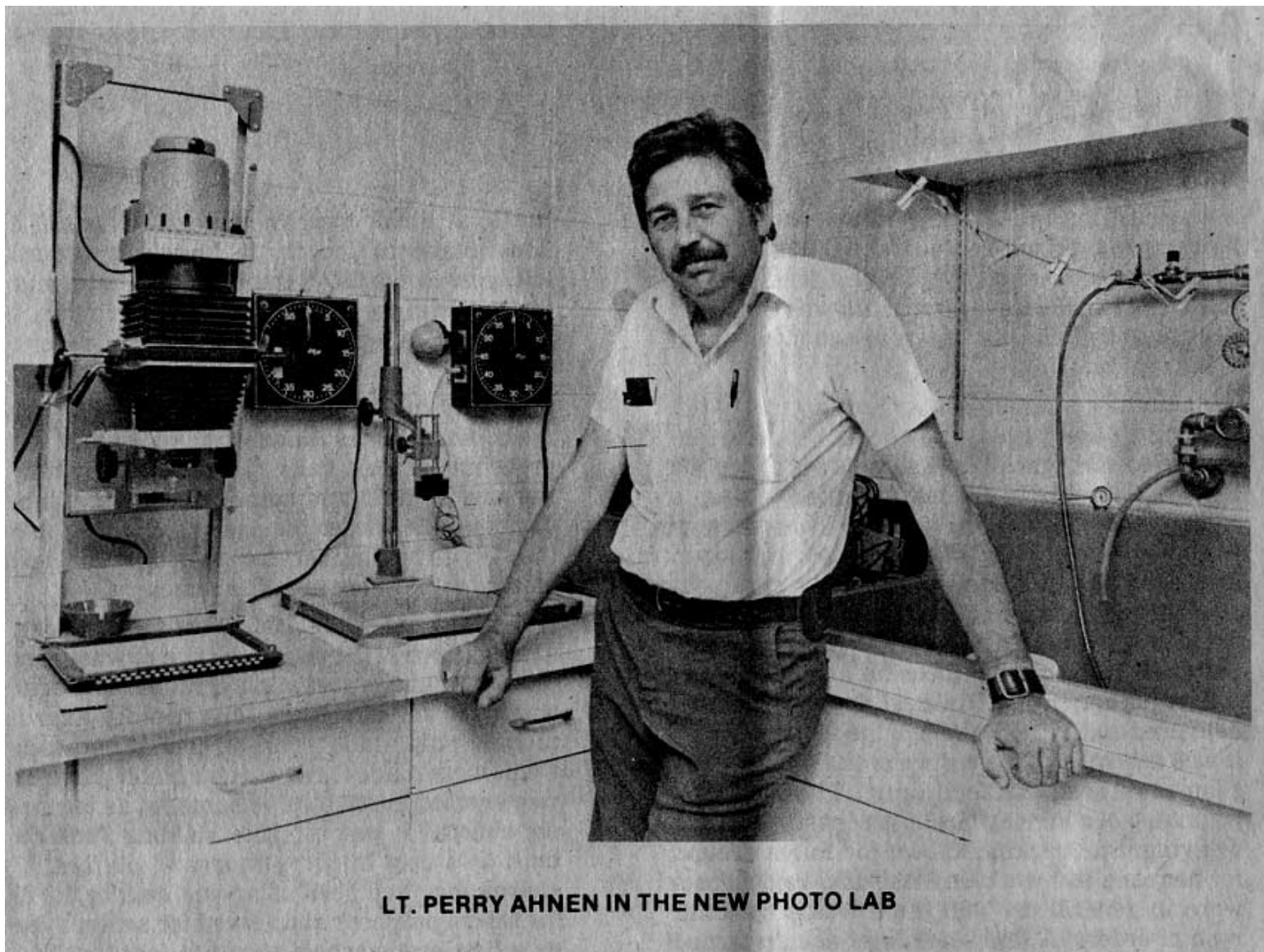

LT. PERRY AHNEN IN THE NEW PHOTO LAB



NEW KITCHEN AT ENFORCEMENT CENTER